

# Notice of works

February 2024

The Department of Transport and Yarra Trams regularly carry out maintenance works across the network to improve operations and passenger experience. The tram powerlines and some poles at the intersection of High Street and Glenferrie Road Malvern have reached the end of their lifecycle. To continue to deliver a safe and reliable tram service to the area, they must be replaced.

## Where?

Works will happen at the intersection of High Street and Glenferrie Road, Malvern.

## When?

24-hour works will take place from **3am, Saturday 16 March to 5am, Monday 18 March 2024.**

## What is happening?

- Setting up work areas including traffic management.
- Removing old and installing new tram power poles.
- Removing old and installing new tram powerlines.
- Reinstating the works area.

## What to expect?

- Vehicles, machinery and contractors on site.
- Kerb to kerb fencing.
- Glenferrie Road will be closed to all traffic between Stanhope and Myamyn streets.
- High Street will be closed to all traffic between Lambeth Avenue and Spring Road.
- Mostly medium noise levels. Some high noise levels when we are excavating the poles.
- Noisiest works will be done between 6am and 10pm.
- Footpaths will remain open.
- There will be no impact to the power supply.

There will be service changes to tram routes 6 and 16. Visit: [yarratrams.com.au/servicechanges](https://yarratrams.com.au/servicechanges)

Businesses located around the works area will remain open during the works. Please continue to support your local businesses during these essential infrastructure works. Pedestrian access to these businesses will remain open at all times.

Please follow signage and traffic management around the work zone and allow extra time when planning your journey.

Works are dependent on weather and ground conditions and subject to change. We appreciate your patience while these works are completed.



For more information about the project call **1800 800 007**.

Authorised by the Department of Transport and Planning, 1 Spring Street, Melbourne.

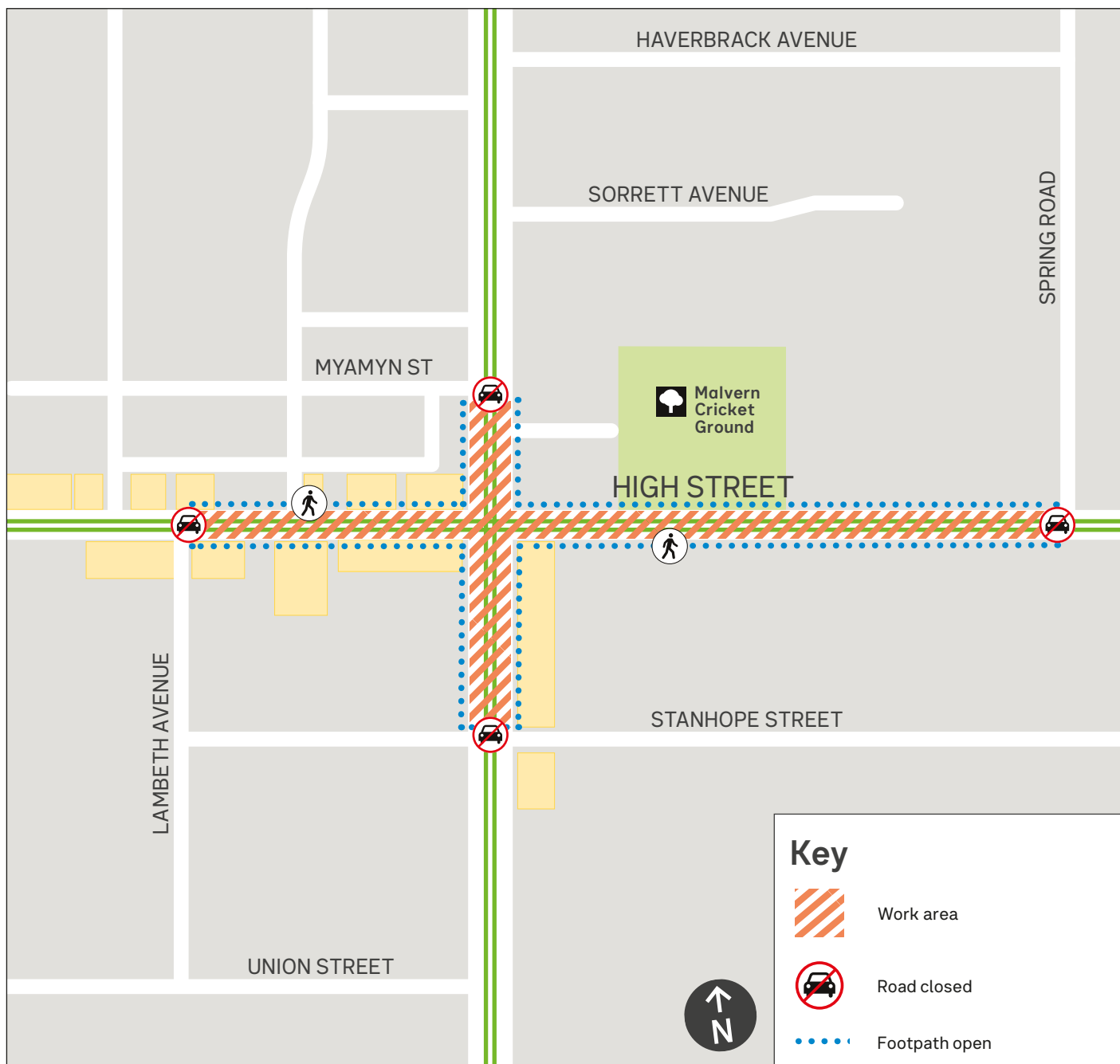

For more information about the project call **1800 800 007**.

Authorised by the Department of Transport and Planning, 1 Spring Street, Melbourne.